

Short pitch precision roller chains (A series)

New Donghua X³ series

Simplex roller chains & bush chains

Part nr.	DIN/ISO 606 Chain no.	ANSI Chain no.	Pitch	Roller diameter	Width between inner plates	Pin diameter	Pin length		Inner plate depth	Plate thickness
			P	d1 max	b1 min	d2 max	L max	Lc max	h2 max	T max
			mm	mm	mm	mm	mm	mm	mm	mm
10025-1X3	*04C-1	*25	6,350	3,30	3,18	2,31	7,90	8,40	6,00	0,80
10035-1X3	*06C-1	*35	9,525	5,08	4,77	3,58	12,40	13,17	9,00	1,30
10041-1X3	085-1	41	12,700	7,77	6,25	3,58	13,75	15,00	9,91	1,30
10040-1X3	08A-1	40	12,700	7,95	7,85	3,96	16,60	17,80	12,00	1,50
10050-1X3	10A-1	50	15,875	10,16	9,40	5,08	20,70	22,20	15,09	2,03
10060-1X3	12A-1	60	19,050	11,91	12,57	5,94	25,90	27,70	18,00	2,42
10080-1X3	16A-1	80	25,400	15,88	15,75	7,92	32,70	35,00	24,00	3,25
100100-1X3	20A-1	100	31,750	19,05	18,90	9,53	40,40	44,70	30,00	4,00
100120-1X3	24A-1	120	38,100	22,23	25,22	11,10	50,30	54,30	35,70	4,80
100140-1X3	28A-1	140	44,450	25,40	25,22	12,70	54,40	59,00	41,00	5,60
100160-1X3	32A-1	160	50,800	28,58	31,55	14,27	64,80	69,60	47,80	6,40
100180-1X3	36A-1	180	57,150	35,71	35,48	17,46	72,80	78,60	53,60	7,20
100200-1X3	40A-1	200	63,500	39,68	37,85	19,85	80,30	87,20	60,00	8,00
100240-1X3	48A-1	240	76,200	47,63	47,35	23,81	95,50	103,00	72,39	9,50

* Bush chain: d1 in the table indicates the external diameter of the bush.

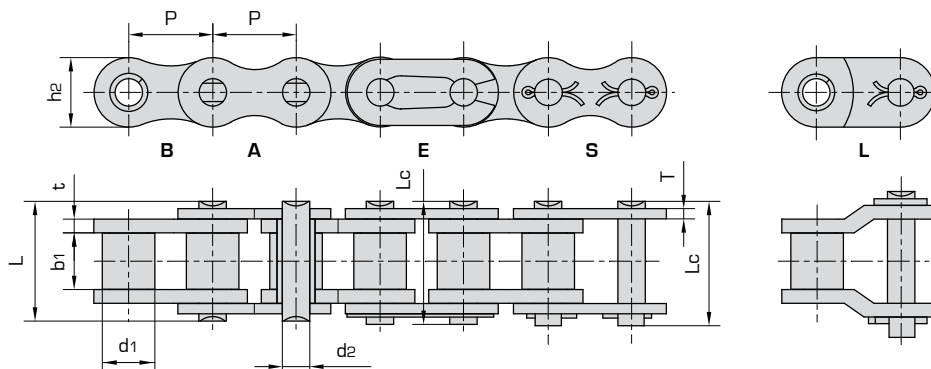



Premium range

Ultimate tensile strength	Average tensile strength	Weight per meter	Available chain parts					
Q min	Q0	q	E	S	L	C	A	B
kN/lbf	kN	kg/m						
3,50/795	5,0	0,15	X			X	X	X
7,90/1795	11,3	0,33	X		X	X	X	X
6,67/1516	12,6	0,41	X		X	X	X	X
14,10/3205	18,6	0,62	X		X	X	X	X
22,20/5045	31,3	1,02	X		X	X	X	X
31,80/7227	43,2	1,50	X		X	X	X	X
56,70/12886	74,3	2,60	X		X	X	X	X
88,50/20114	107,6	3,91		X	X		X	X
127,00/28864	163,1	5,62		X	X		X	X
172,40/39182	222,5	7,50		X	X		X	X
226,80/51545	266,9	10,10		X	X		X	X
280,20/63682	361,1	13,45		X	X		X	X
353,80/80409	466,8	16,15		X	X		X	X
510,30/115977	671,6	23,20		X	X		X	X



Our NEW DONGHUA X3 SERIES is within our Premium Quality product range offering 3 times better wear resistance, fatigue resistance and higher precision than our standard range. By using new hardening technologies and special anti-friction coating technology on the pin surface, the coefficient of friction between pin and bush is reduced to a minimum. Extreme wear resistance is the result. All Donghua roller chains are: Pre-loaded, Fatigue resistant, Wear resistant and Pre-lubricated. Donghua simplex, duplex and triplex roller chains are manufactured according to ISO 606 DIN8187, standard pre-loaded, pre-lubricated, do have seamless rollers and are marked with production batch code number for complete traceability. All Donghua roller chains are sealed in plastic bags and packed in cardboard boxes with clear ISO 606 DIN descriptions and safety instructions. Standard packaging size is 5 meter box, reels are available on request. Cut to length service is available on request. Several test certificates like breaking load, length tolerance and material analyses are possible and available on request. Rollers chains which are needed for 'run as pairs' applications can be matched as pairs on request. DIN, 1/2DIN and 1/3DIN length tolerance are possible, please ask us for a quotation. For high temperature, low temperature, food application or special environments different kind of special lubricants are available. Please ask our sales team for any special needs. For drive chain calculation and right dimension check, please contact our engineering department, also see drive chain calculation data sheet on page 301. By filling this data sheet and sending this to our engineering department you will receive a detailed drive chain calculation including life time expectation. Sprockets are available for all roller chains, with pilot bore, fixed bore, keyway, setscrew or bearing bore with grooves. Standard toothing, hardened toothing or special toothing are possible with pilot bore, fixed bore or taper bush. Chain tools, tensioners and chain lubricants please see page 302-310.