

Short pitch precision roller chains (B series)

CP Hard Chromized Pins

Simplex roller chains

Part nr.	DIN/ISO 606 Chain no.	Pitch	Roller diameter	Width between inner plates	Pin diameter	Pin length		Inner plate depth	Plate thickness
		P	d1 max	b1 min	d2 max	L max	Lc max	h2 max	T max
		mm	mm	mm	mm	mm	mm	mm	mm
10004B-1CP	04B-1CP	6,000	4,00	2,80	1,85	6,80	7,8	5,00	0,60
10005B-1CP	05B-1CP	8,000	5,00	3,00	2,31	8,20	8,9	7,10	0,80
10006B-1CP	*06B-1CP	9,525	6,35	5,72	3,28	13,15	14,1	8,20	1,30
10008B-1CP	08B-1CP	12,700	8,51	7,75	4,45	16,70	18,2	11,80	1,60
10010B-1CP	10B-1CP	15,875	10,16	9,65	5,08	19,50	20,9	14,70	1,70
10012B-1CP	12B-1CP	19,050	12,07	11,68	5,72	22,50	24,2	16,00	1,85
10016B-1CP	16B-1CP	25,400	15,88	17,02	8,28	36,10	37,4	21,00	4,15/3,1
10020B-1CP	20B-1CP	31,750	19,05	19,56	10,19	41,30	45,0	26,40	4,50/3,5
10024B-1CP	24B-1CP	38,100	25,40	25,40	14,63	53,40	57,8	33,20	6,00/4,8
10028B-1CP	28B-1CP	44,450	27,94	30,99	15,90	65,10	69,5	36,70	7,50/6,0
10032B-1CP	32B-1CP	50,800	29,21	30,99	17,81	66,00	71,0	42,00	7,00/6,0
10040B-1CP	40B-1CP	63,500	39,37	38,10	22,89	82,20	89,2	52,96	8,50/8,0
10048B-1CP	48B-1CP	76,200	48,26	45,72	29,24	99,10	107,0	63,80	12,00/10,0
10056B-1CP	56B-1CP	88,900	53,98	53,34	34,32	114,60	123,0	77,80	13,50/12,0
10064B-1CP	64B-1CP	101,600	63,50	60,96	39,40	130,00	138,5	90,17	15,00/13,0
10072B-1CP	72B-1CP	114,300	72,39	68,58	44,48	147,40	156,4	103,60	17,00/15,0

* Straight side plates

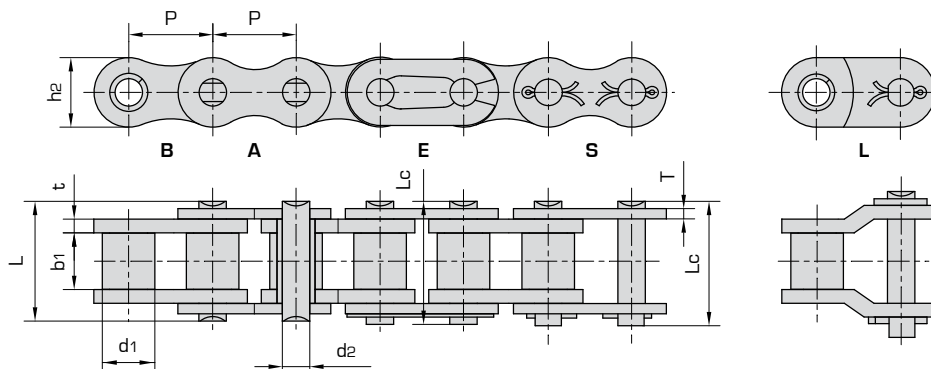

Ultimate tensile strength	Average tensile strength	Weight per meter	Available chain parts						
Q min	Q0	q							
kN/lbf	kN	kg/m	E	S	L	C	A	B	
3,0/682	3,2	0,11	X		X	X	X	X	
5,0/1136	5,9	0,20	X		X	X	X	X	
9,0/2045	10,4	0,41	X		X	X	X	X	
18,0/4091	19,4	0,69	X	X	X	X	X	X	
22,4/5091	27,5	0,93	X	X	X	X	X	X	
29,0/6591	32,2	1,15	X	X	X	X	X	X	
60,0/13636	77,1	2,71	X	X	X	X	X	X	
95,0/21591	112,8	3,70	X	X	X		X	X	
160,0/36364	178,0	7,10		X	X		X	X	
200,0/45455	236,4	8,50		X	X		X	X	
250,0/56818	277,5	10,25		X	X		X	X	
355,0/80682	394,0	16,35		X	X		X	X	
560,0/127272	621,6	25,00		X	X		X	X	
850,0/193180	940,0	35,78		X	X		X	X	
1120,0/254544	1240,0	46,00		X	X		X	X	
1400,0/318180	1550,0	60,80		X	X		X	X	



Donghua CP roller chains are built with hard chromized pins. The surface hardness is more than 1100 HV10 offering a +30% higher wear resistance than standard case hardened pins. Donghua CP roller chain are used for tough environments, high speed, high frequency of movement in the bearing area resisting wear much better than case hardened pins. In combination with highly sophisticated lubricant this technology brings a unique performance in wear resistance. All Donghua roller chains are: Pre-loaded, Fatigue resistant, Wear resistant and Pre-lubricated. Donghua simplex, duplex and triplex roller chains are manufactured according to ISO 606 DIN8187, standard pre-loaded, pre-lubricated, do have seamless rollers and are marked with production batch code number for complete traceability. All Donghua roller chains are sealed in plastic bags and packed in cardboard boxes with clear ISO 606 DIN descriptions and safety instructions. Standard packaging size is 5 meter box, reels are available on request. Cut to length service is available on request. Several test certificates like breaking load, length tolerance and material analyses are possible and available on request. Rollers chains which are needed for 'run as pairs' applications can be matched as pairs on request. DIN, 1/2DIN and 1/3DIN length tolerance are possible, please ask us for a quotation. For high temperature, low temperature, food application or special environments different kind of special lubricants are available. Please ask our sales team for any special needs. For drive chain calculation and right dimension check, please contact our engineering department, also see drive chain calculation data sheet on page 301. By filling this data sheet and sending this to our engineering department you will receive a detailed drive chain calculation including life time expectation. Sprockets are available for all roller chains, with pilot bore, fixed bore, keyway, setscrew or bearing bore with grooves. Standard toothing, hardened toothing or special toothing are possible with pilot bore, fixed bore or taper bush. Chain tools, tensioners and chain lubricants please see page 302-310.